

CATCHERS CREEK 2ND ADDITION

City of Andover
Anoka County, Minnesota

REVISION	DATE	BY	REMARKS
1	07/15/13	MS	ISSUED FOR PERMIT
2	07/15/13	MS	ISSUED FOR PERMIT
3	07/15/13	MS	ISSUED FOR PERMIT
4	07/15/13	MS	ISSUED FOR PERMIT
5	07/15/13	MS	ISSUED FOR PERMIT
6	07/15/13	MS	ISSUED FOR PERMIT
7	07/15/13	MS	ISSUED FOR PERMIT
8	07/15/13	MS	ISSUED FOR PERMIT
9	07/15/13	MS	ISSUED FOR PERMIT
10	07/15/13	MS	ISSUED FOR PERMIT
11	07/15/13	MS	ISSUED FOR PERMIT
12	07/15/13	MS	ISSUED FOR PERMIT
13	07/15/13	MS	ISSUED FOR PERMIT
14	07/15/13	MS	ISSUED FOR PERMIT
15	07/15/13	MS	ISSUED FOR PERMIT
16	07/15/13	MS	ISSUED FOR PERMIT
17	07/15/13	MS	ISSUED FOR PERMIT
18	07/15/13	MS	ISSUED FOR PERMIT
19	07/15/13	MS	ISSUED FOR PERMIT
20	07/15/13	MS	ISSUED FOR PERMIT
21	07/15/13	MS	ISSUED FOR PERMIT
22	07/15/13	MS	ISSUED FOR PERMIT
23	07/15/13	MS	ISSUED FOR PERMIT
24	07/15/13	MS	ISSUED FOR PERMIT
25	07/15/13	MS	ISSUED FOR PERMIT
26	07/15/13	MS	ISSUED FOR PERMIT
27	07/15/13	MS	ISSUED FOR PERMIT
28	07/15/13	MS	ISSUED FOR PERMIT
29	07/15/13	MS	ISSUED FOR PERMIT
30	07/15/13	MS	ISSUED FOR PERMIT
31	07/15/13	MS	ISSUED FOR PERMIT
32	07/15/13	MS	ISSUED FOR PERMIT
33	07/15/13	MS	ISSUED FOR PERMIT
34	07/15/13	MS	ISSUED FOR PERMIT
35	07/15/13	MS	ISSUED FOR PERMIT
36	07/15/13	MS	ISSUED FOR PERMIT
37	07/15/13	MS	ISSUED FOR PERMIT
38	07/15/13	MS	ISSUED FOR PERMIT
39	07/15/13	MS	ISSUED FOR PERMIT
40	07/15/13	MS	ISSUED FOR PERMIT
41	07/15/13	MS	ISSUED FOR PERMIT
42	07/15/13	MS	ISSUED FOR PERMIT
43	07/15/13	MS	ISSUED FOR PERMIT
44	07/15/13	MS	ISSUED FOR PERMIT
45	07/15/13	MS	ISSUED FOR PERMIT
46	07/15/13	MS	ISSUED FOR PERMIT
47	07/15/13	MS	ISSUED FOR PERMIT
48	07/15/13	MS	ISSUED FOR PERMIT
49	07/15/13	MS	ISSUED FOR PERMIT
50	07/15/13	MS	ISSUED FOR PERMIT

DATE: 6/22/15
 PREPARED BY: [Signature]
 CHECKED BY: [Signature]
 DATE: 6/22/15
 I hereby certify that this plan, specification, or report was prepared by me or under my direct supervision and that I am a duly Licensed Professional Engineer under the laws of the State of Minnesota.

HEDLUND
 ENGINEERING
 2008 FIVE OAK DRIVE
 BOSTON, MA 02122
 PHONE: (617) 405-8600
 FAX: (617) 405-8608

CATCHERS CREEK 2ND ADDITION
 UTILITY PLAN
 MARK SMITH
 2120 OAK LAKE DRIVE
 SEAN, PAUL, MI 55110

PRELIMINARY
 NOT FOR CONSTRUCTION

Scale 1" = 50'

- LEGEND:**
- FIELD DEDICATED WETLAND
 - EXISTING WATERMAIN
 - EXISTING STORM SEWER
 - EXISTING FENCE
 - PROPOSED SANITARY SEWER
 - PROPOSED WATERMAIN
 - PROPOSED STORM SEWER

GENERAL CONSTRUCTION NOTES:

- 1) The Contractor shall be responsible for the design of all structures shown on this plan. The Contractor shall be responsible for the design of all structures shown on this plan. The Contractor shall be responsible for the design of all structures shown on this plan.
- 2) The Contractor shall be responsible for the design of all structures shown on this plan. The Contractor shall be responsible for the design of all structures shown on this plan. The Contractor shall be responsible for the design of all structures shown on this plan.
- 3) The Contractor shall be responsible for the design of all structures shown on this plan. The Contractor shall be responsible for the design of all structures shown on this plan. The Contractor shall be responsible for the design of all structures shown on this plan.
- 4) The Contractor shall be responsible for the design of all structures shown on this plan. The Contractor shall be responsible for the design of all structures shown on this plan. The Contractor shall be responsible for the design of all structures shown on this plan.
- 5) The Contractor shall be responsible for the design of all structures shown on this plan. The Contractor shall be responsible for the design of all structures shown on this plan. The Contractor shall be responsible for the design of all structures shown on this plan.

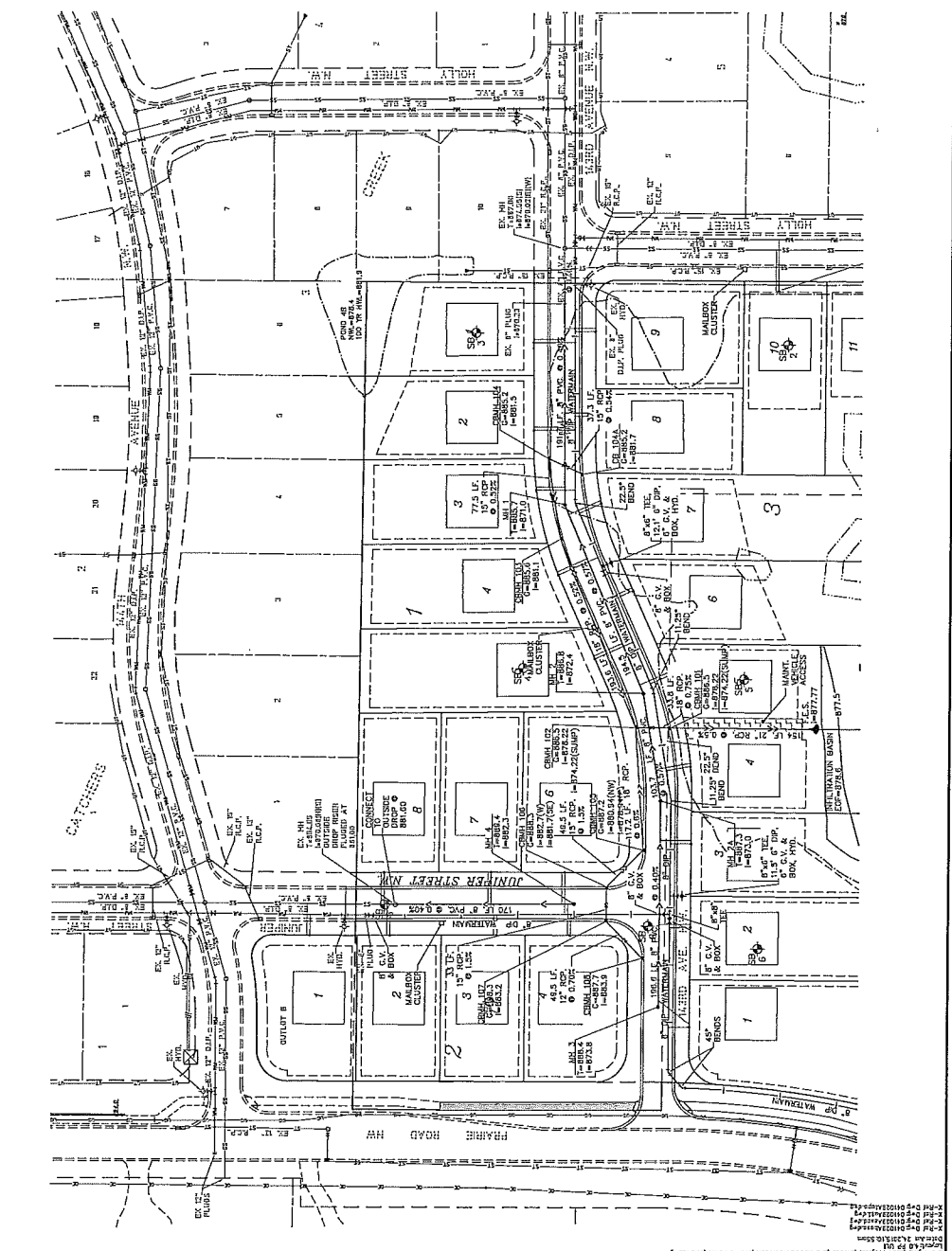

CATCHERS CREEK 2ND ADDITION

City of Andover
Anoka County, Minnesota

LEGEND:

- FIELD ILLUSTRATED WETLAND
- EXISTING SANITARY SEWER
- EXISTING WATERMAIN
- EXISTING STORM SEWER
- EXISTING FENCE
- PROPOSED SANITARY SEWER
- PROPOSED WATERMAIN
- PROPOSED STORM SEWER

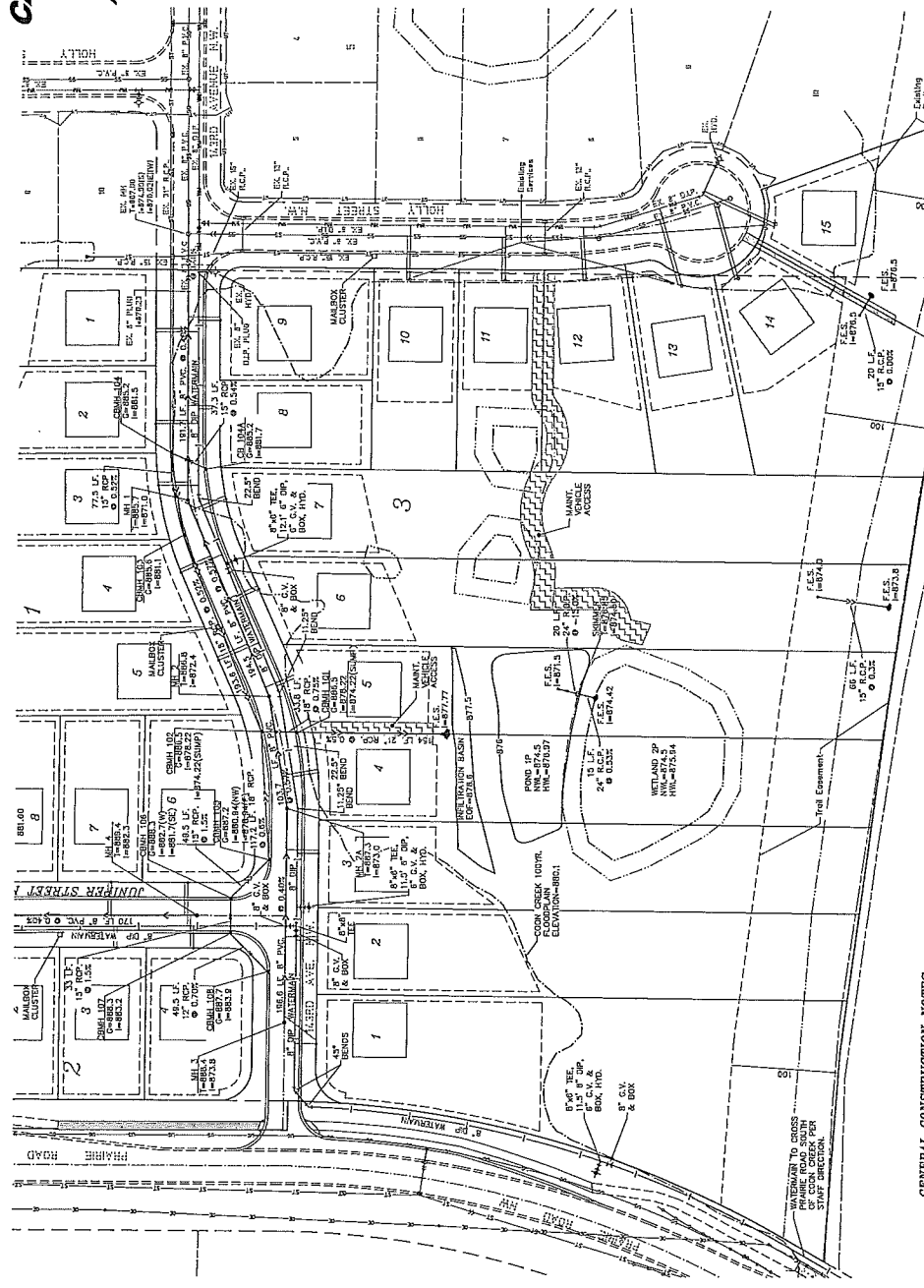

- GENERAL CONSTRUCTION NOTES:**
- 1) Existing Utility Locations As Per City of Andover Utility Department Records are to be used unless otherwise noted. Utility Plans to be used in conjunction with this plan.
 - 2) The Contractor Shall Notify all Property Owners and Adjacent Property Owners of the Location of all Underground Utilities in Advance of Construction. The Contractor Shall be Responsible for Locating and Marking All Utilities. The Contractor Shall be Responsible for Locating and Marking All Utilities. The Contractor Shall be Responsible for Locating and Marking All Utilities.
 - 3) The Contractor Shall Notify all Property Owners and Adjacent Property Owners of the Location of all Underground Utilities in Advance of Construction. The Contractor Shall be Responsible for Locating and Marking All Utilities. The Contractor Shall be Responsible for Locating and Marking All Utilities.
 - 4) The Contractor Shall be Responsible for Locating and Marking All Utilities. The Contractor Shall be Responsible for Locating and Marking All Utilities.

**PRELIMINARY
NOT FOR CONSTRUCTION**

Scale 1" = 50'

**CATCHERS CREEK 2ND ADDITION
UTILITY PLAN**

MARK SMITH
2120 Old Lake Drive
Shelby Park, MN 55110

DATE: 07/27/10
SCALE: C-4.1

HEADLUND ENGINEERING

2008 PM DAY
2008 PM DAY
Phone: (612) 405-8000
Fax: (612) 405-8008

PROJECT NO. 08-001

CONTRACTOR: [Signature]
DATE: 07/27/10

NO.	REVISION	DATE
1	ISSUED FOR PERMITS	07/27/10
2	ISSUED FOR PERMITS	07/27/10
3	ISSUED FOR PERMITS	07/27/10